

A black SUV is towing a white and black caravan on a sandy beach. The background is a large, layered rock formation with horizontal strata in shades of orange, red, and white. The top of the formation is covered in green vegetation. The sky is blue with some clouds.

BRÜDER

ADX-21



# ADX-21

The ADX-21 seamlessly blends strength, luxury and performance to deliver a full-size off-road caravan without compromise. Constructed with a fully composite body the ADX-21 weighs less than 2.5 tonne. Featuring Bruder's world renowned patented suspension it ensures a smooth and stable towing experience, redefining off-road travel with an unparalleled combination of toughness and luxury.







# Reliable Adventures

The ADX-21 is engineered for extended off-grid adventures, delivering industry-leading 12V performance. Equipped with globally recognised and supported Victron electrical systems, it features a 3000W inverter, over 1600W of solar (800W standard), and a 1200Ah lithium battery system (300Ah standard).



The image shows the interior of a modern caravan. In the foreground, a bed is made with a grey and white patterned duvet and two pillows. One pillow has a geometric pattern, and the other is plain white. To the right of the bed, there is a white storage cabinet with a black handle. Above the cabinet, there is a large window with a white frame, showing a view of a beach and the ocean at sunset. The sky is orange and yellow, and the water is calm. The interior walls are white, and the ceiling is dark. A skylight is visible in the upper left corner of the image.

# Storage and Flexibility

Designed for ultimate versatility, the ADX-21 offers thoughtfully crafted layouts to suit both couples and families. The family model includes up to three bunk beds, while every layout maximises the 21-foot interior for comfort and practicality.





# Bruder Suspension

The ADX-21 is equipped with Bruder's renowned suspension system - trusted by the Australian Defence Force (ADF) for specialised operations. Featuring 12 inches of adjustable suspension travel, the system effortlessly adapts to varying terrains, from highways to rugged off-road landscapes. Its unique load-sharing and non load-sharing modes provide optimal stability and handling, while the ability to tow on two or three wheels adds unmatched flexibility.



# Couples Layout

## Dual Entry

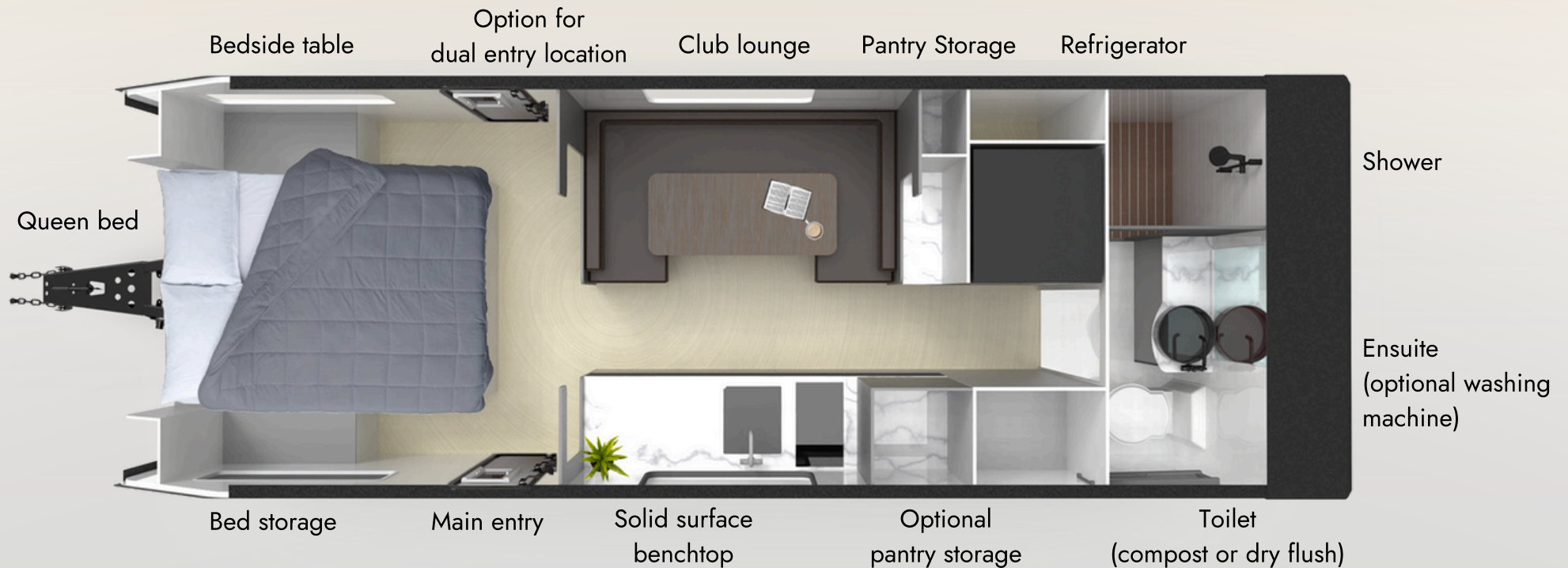



# Couples Layout

## Wet-Room Entry

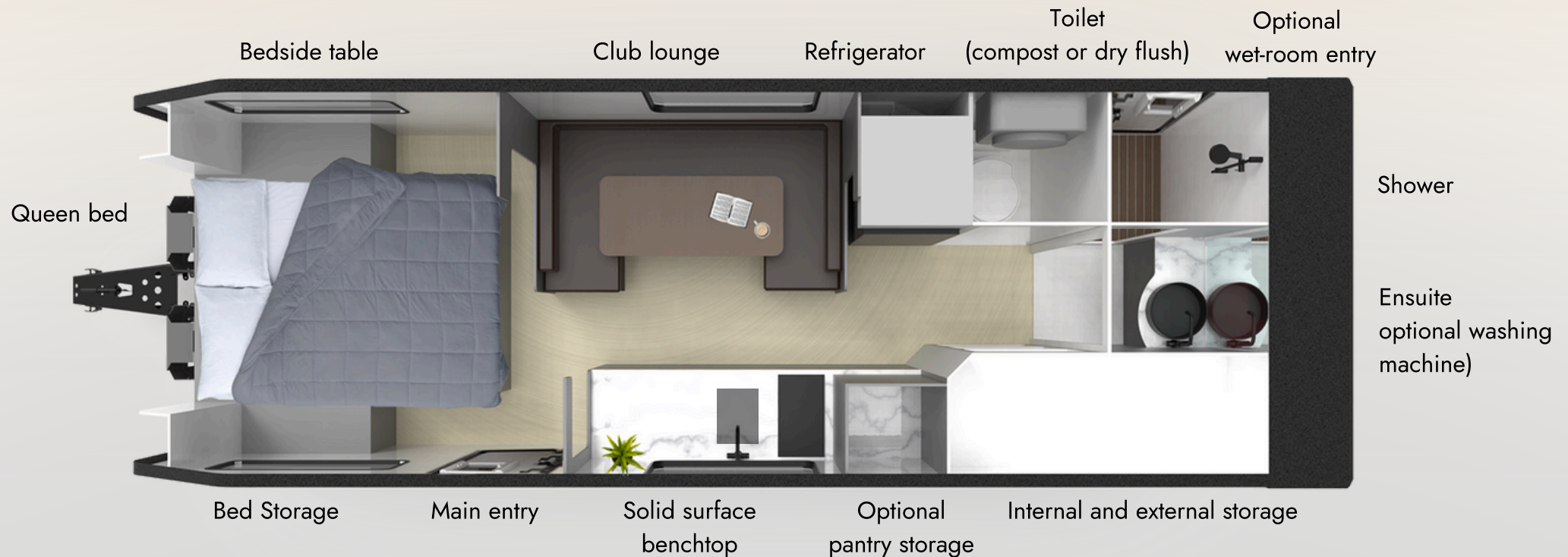



# Couples Layout

## Internal Measurements

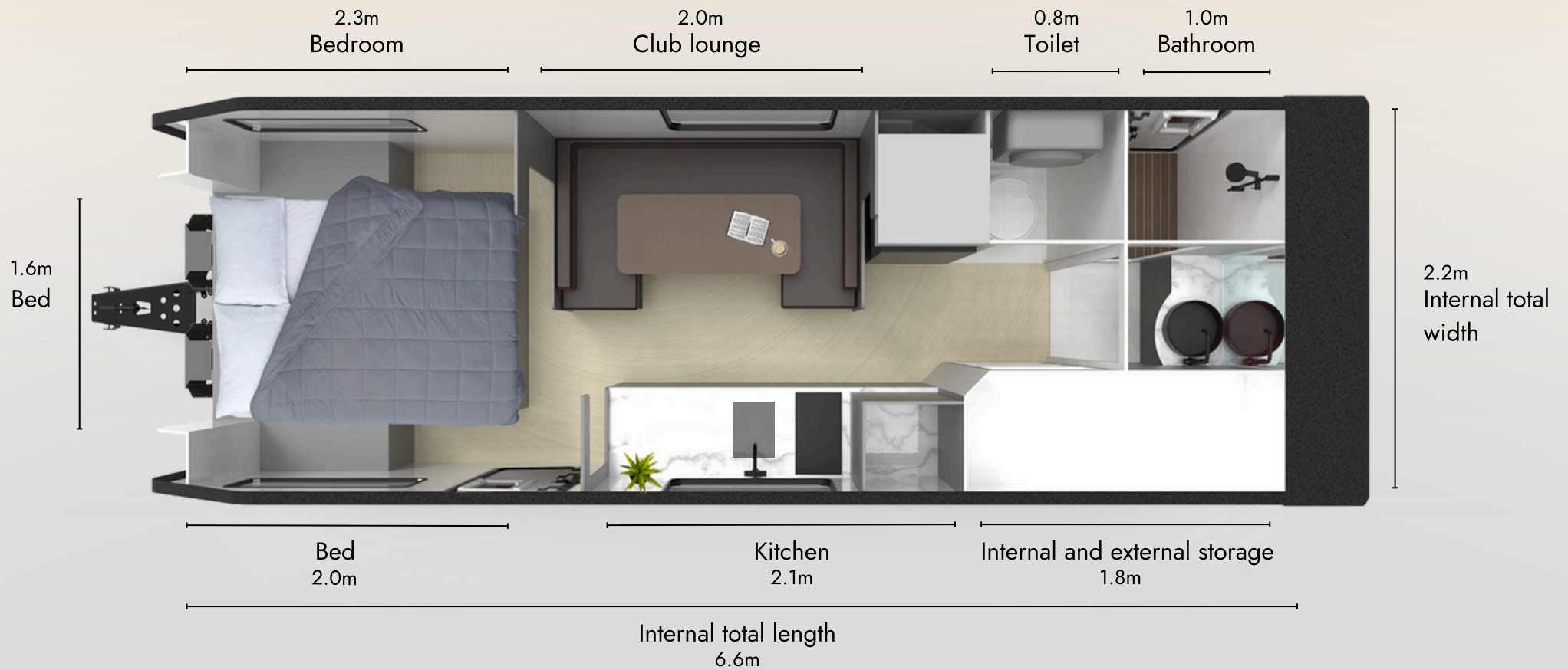



The image shows the interior of a modern off-road caravan. On the left is a kitchenette with a white countertop, a black induction cooktop, a black sink with a curved faucet, and a black window blind. On the right is a black leather sofa. In the background, a bed with a white patterned duvet and two patterned pillows is visible. The interior is white with black accents. Large panoramic windows on both sides offer views of a beach and a grassy field. The ceiling has a skylight and a vent.

# Seamless Living

Forget the hassle of climbing double or triple steps - the ADX-21's suspension lowers for effortless entry, redefining accessibility in the off-road caravan segment. Once inside, expansive panoramic windows keep the surrounding environment in sight, enhancing the connection to the outdoors. It's fully composite body construction provides exceptional strength while enhancing thermal efficiency, ensuring a comfortable interior even in extreme conditions.

From plush interiors to expertly engineered layouts, every detail reflects Bruder's unwavering commitment to luxury and adventure.



# Family Layout





# Family Layout

## Internal Measurements

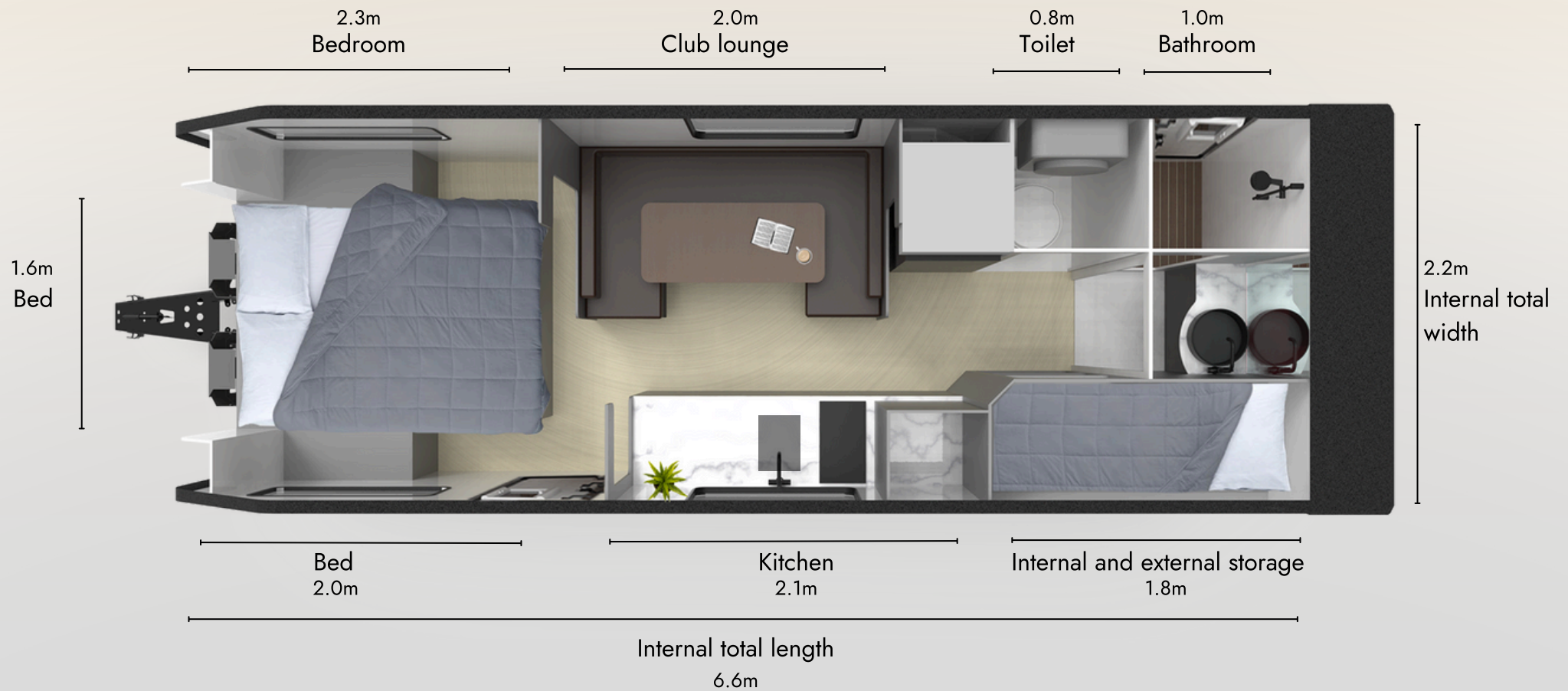



# Storage and Flexibility

Clever compartments and large storage areas ensure you have room for all of your essentials, from clothing to outdoor equipment. The family layout offers additional storage, while the exterior storage options allow easy access to your gear without disrupting the interior space, with over 1500L of storage in the front through-boot alone.





# External Measurements

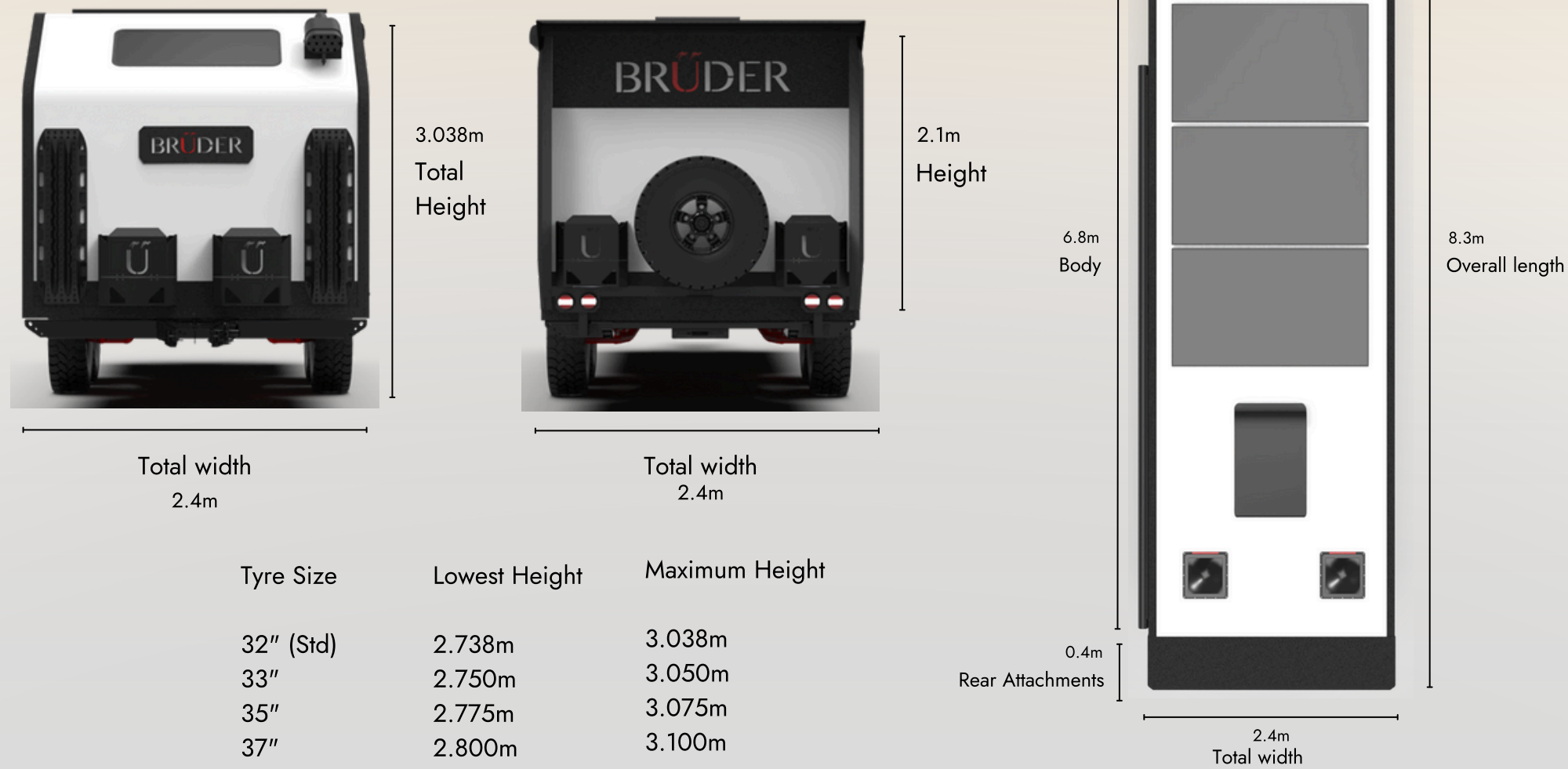



# Key Features

## Standard Inclusions

### Chassis, suspension and body

- Fully engineered & sealed 125mmx75mmx4mm chassis
- Fully welded and sealed laser cut sections
- Two-pac painted chassis
- 30mm closed cell insulated composite body construction
- Bruder designed air suspension system with eight mono-tube remote-canister shock absorbers
- 3.5 tonne ATM
- Cruisemaster DO35 hitch
- Hydraulic disc brakes
- 17-inch alloy wheels with 265/70R17 tyres
- Rear mounted bar with spare tyre
- Two jerrycan mounts
- Manual roll out awning on LHS
- External drop-down table
- Front through boot storage
- Premium double layered windows

### Plumbing

- 200L drinking water tank
- 75L grey water tank
- Seperate internal shower, vanity and toilet
- Composting toilet

### Electrical

- Victron Energy 12V power system
- 300ah lithium battery capacity
- 3000W Inverter
- Internal & external LED lighting
- Internal reading lights
- 800W solar bank
- Touch screen power management system
- 5 x internal AC outlets
- 4 x 12V and USB outlets

### Kitchen

- Twin burner induction cooktop
- Internal kitchen sink
- Solid surface benchtops
- Pull-out mixer
- Built-in under-sink bin

### Internal

- Internal AC and DC power outlets
- Internal refrigerator / freezer
- Roof mounted air-conditioning
- Diesel powered internal heating and hot water system
- Full sized queen bed (1530mm x 2030mm)
- Internal fans
- Block-out blinds and in-built insect mesh
- Television (requires internet connection)



# Optional Extras

## Chassis, suspension and body

- 18" alloy wheels with 33/50R18 tyres
- 18" alloy wheels with 295/70R18 tyres
- 18" alloy wheels with 37/12.50R18 tyres

## Interior

- Choice of cabinetry colour
- Choice of sofa upholstery, bed head colour and materials

## Exterior

- Right hand side 5m electrically controlled awning
- Annexe kit to suit 5m awning
- External shower tent
- Draft skirt

## Appliances

- Washing and drying machine
- Anti-theft system with GPS

## Electrical

- 240V 2.2KVA generator
- Up to 1200Ah lithium battery pack
- Up to 1600W solar bank
- Starlink provision

## Recovery

- MaxTrax recovery boards
- Stone guard protection system
- Wireless rear view window camera
- Tyre inflation kit
- Wireless airbag controller







## Australia

115 Muriel Avenue,  
Moorooka, QLD, 4105,  
Australia  
+61 7 3172 8838  
[sales@bruderx.com](mailto:sales@bruderx.com)

## United States

3300 Royalty Row,  
Irving, TX 75062, United  
States  
+1 (972) 944 9700  
[sales@bruderx.com](mailto:sales@bruderx.com)

### Disclaimer:

Bruder reserve the right to make alterations to the layout and design at any stage. This entails modifications for improved functionality, user experience and aesthetic appeal. The North American model will feature a mirrored layout. The orientation and placement of certain elements may differ in the final design.

**BRÜDER**